



Pocket 1195

Factory-Built Exchange



1st Mile Network

Sales
Design
Permit



Factory Manufacturers

Expertly Built



Last Mile Logistics

Site Work Contractors
Delivery
Installation Contractors

Pocket 1195

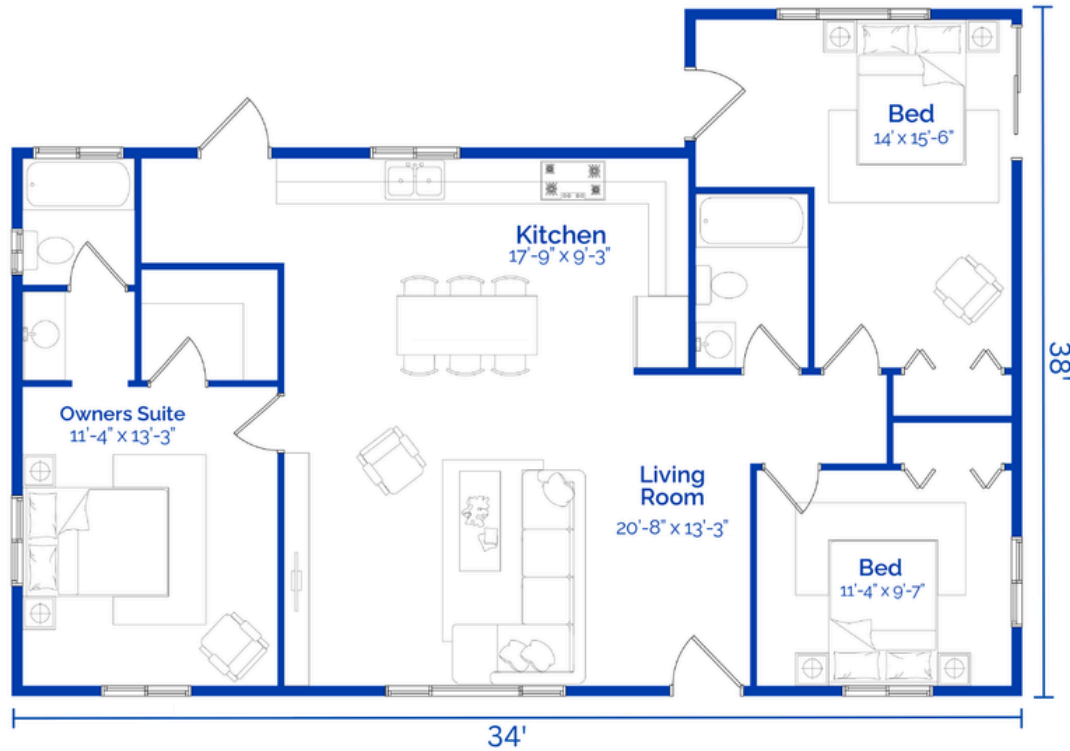

Pocket 1195

Package

Choose the type of package you desire.

Details on packages are located in the "More Details" button above

- Advantage
- Premium
- PreFabulous

Itemized Upgrades Available

Choose individual common upgrades

Bidet Prep \$250 ea - Electrical outlet near each toilet

Cable Outlet \$275 ea - Recessed Box Mid-wall for flush-mount entertainment centers

Barn Door Style Openings \$750 ea

Sliding Glass Door \$875 - (instead of French Doors)

- Front Eave \$1,750 - 24' overhang with recessed lights
- Stucco \$4,500 - 3 coat stucco applied on-site
- Metal Roof \$6,500 - Standing Seam Powder Coated
- ADA accessibility pkg \$7,590
- Snow Load (Engineering Fee) \$2750
- Porches, Decks & Portico's (Select PreFabulous Below)

Fire Resistance

Make a choice of items to protect your home. Some may be required by code. Some are there to make your home impervious to the high risk.

- None
- Wildland Urban Interface \$3,750
- Fire Sprinkler System (may be req'd by code) \$6,500
- Extreme Fire Resistance Package (WUI; Fire Sprinklers; 1 hr rated walls, roof, eaves; Fire paint; Fire Caulking; Metal Roof; triple pane windows; and other measures) \$19,565

Style Packages

Choose one of the standard packages we offer for materials and finishes. These are no additional charge. See details by clicking on the link above

- Modern
- Traditional
- Glam
- Farmhouse

Foundation Style

Choose a foundation style you prefer

- Helical/Push Piers - Included
- Slab Foundation - \$2,500
- Stem Wall - \$4,500 for engineering + cost of labor/materials (quoted after engineering)
- On a Hill/Excavations - \$3,500 engineering fee + cost of labor/materials (quoted after engineering)

Land Preparation

Choose the items you will need to have worked on your land

- Site Clearing & Demolition (Separate Quote)
- Survey - \$4500
- Grading (Separate Quote)
- Landscaping (Separate Quote)
- Sidewalks (Separate Quote)
- Retaining Walls - Assessment & Engineering cost \$5,500
- Parking - (separate quote)

Pocket 1195

Water Connection

Distance from a water source to the new home

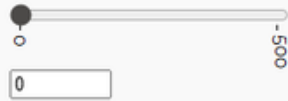

Waste Water Type

Choose to connect to a WasteWater source

- Connect to an existing Septic/Sewer - \$0
- Pristine EcoWater System, an advanced wastewater treatment system - \$17,360
- New Septic System Assessment & Engineering - \$6,500 (A separate quote for the system itself will be provided)

Waste Water Connection

Distance from new home to existing wastewater connections

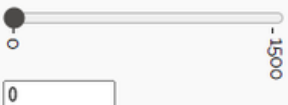

Electrical Connection Type

Choose to either connect to the main panel or go off-grid with a backup source

- Main Panel Upgrade to 225 amp busbar capacity - \$3,450 (Note: state law requires a 225 amp busbar listed on the panel rating)
- Off Grid Solar/Battery/Inverter w/ main panel backup - \$19,350
- Off Grid Solar/Battery/Inverter w/ generator backup - \$20,610

Electrical Connection Length

Measure the distance from where you want the new home to your electric service (if you choose one of the battery system options set this to zero)

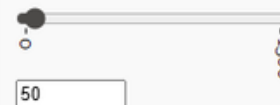

Delivery

Look up the distance to your home from 1801 Santa Clara, Fresno



Find Route and Distance

Modular Building Price

Estimated cost of labor

\$180,565

Package Cost

From Selections chosen

\$5,054

Itemized Upgrades

\$0

Fire Resistance Cost

\$0

Estimated Site Cost

Estimated cost of materials

\$11,030

Cash Price

\$196,649

Total estimated cost for your construction project.

Request a Site Visit!

Pocket 1195

Design Packages

FBX Farm House Finishes

Ceiling Fan, Chandelier, Ceiling Light, Closet Door Pulls
 Bathroom Vanity Light, Kitchen Pendant Lights, Exterior Lighting, Bathroom Sink Fixture
 Bathroom Vanity/Sink Combo, Bathroom Hardware, Bathroom Mirror, Shower Fixtures
 Kitchen Faucet, Interior Door Knobs, Kitchen Cabinet Handles, Front Door Knob

FBX Gold Glam Finishes

Ceiling Fan, Chandelier, Ceiling Light, Closet Door Pulls
 Bathroom Vanity Light, Kitchen Pendant Lights, Exterior Lighting, Bathroom Sink Fixture
 Bathroom Vanity/Sink Combo, Bathroom Hardware, Bathroom Mirror, Shower Fixtures
 Kitchen Faucet, Interior Door Knobs, Kitchen Cabinet Handles, Front Door Knob

FBX Rustic Cabin Finishes

Ceiling Fan, Chandelier, Ceiling Light, Closet Door Pulls
 Bathroom Vanity Light, Kitchen Pendant Lights, Exterior Lighting, Bathroom Sink Fixture
 Bathroom Vanity/Sink Combo, Bathroom Hardware, Bathroom Mirror, Kitchen Cabinet Handles
 Kitchen Faucet, Interior Door Knobs, Front Door Knob

FBX Modern Finishes

Ceiling Fan, Chandelier, Ceiling Light, Closet Door Pulls
 Bathroom Vanity Light, Kitchen Pendant Lights, Exterior Lighting, Bathroom Sink Fixture
 Bathroom Vanity/Sink Combo, Bathroom Hardware, Bathroom Mirror, Shower Fixtures
 Kitchen Faucet, Interior Door Knobs, Kitchen Cabinet Handles, Front Door Knob

Pocket 1195

High Efficiency Walls (SIP)
Mini-Split HVAC
All-Electric
Laundry

Solar Included
Zero-Energy Ready
Fire Suppression
Fire Rated



5 Design Packages
Delivered anywhere
Perfect for Backyard

SIPCrete &
Helical Piles Available
Simple Installation